

TYPE.KAZ

V JET (FLAT) SPRAY NOZZLE

Data Sheet 11111502 Rev.01

SPRAY CHARACTERISTICS

Uniform distribution flat spray pattern with high impact and minimum atomisation
Full fan - no tapered edges and therefore no overlapping required
Minimal flow deviation through range of pressures

NOZZLE PROPERTIES

One piece body with hexagon profile
Available in a range of BSPT thread sizes
Standard material availability of 303, 316 and 440 Hardened Stainless Steel
Available spray angles of; 0°, 15°, 25°, 40°, 50° (quoted @ 10 Bar.G)

KAITE

tel: **+44 (0) 1744 607361**
email: **sales@kaite.eu**
web: **kaite.eu**



Dimensions and Weights

DIMENSIONS (mm)				WEIGHT (g)
THREAD	A Hex	B	C	
1/8"	11.3	17.5	9.5	10
1/4"	15.3	24.5	13.0	23

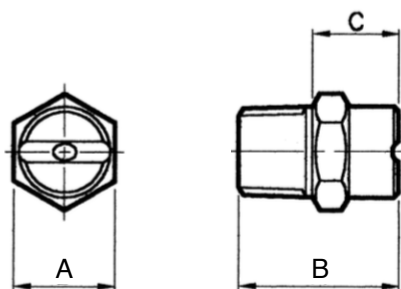

Capacity Chart

NOZZLE NUMBER	THREAD SIZE	ORIFICE DIA (mm)	FLOW RATE IN LITRES/MIN AT Bar.G							
			15	20	25	35	40	50	60	70
4	1/8" 1/4"	1.25	3.5	4.1	4.6	5.4	5.8	6.5	7.1	7.6
5	1/8" 1/4"	1.40	4.4	5.1	5.7	6.7	7.2	8.1	8.8	9.5
6	1/8" 1/4"	1.50	5.3	6.1	6.8	8.1	8.7	9.7	10.6	11.4
7	1/8" 1/4"	1.65	6.2	7.1	8.0	9.4	10.1	11.3	12.4	13.4
8	1/8" 1/4"	1.75	7.1	8.2	9.1	10.8	11.5	12.9	14.1	15.3
9	1/8" 1/4"	2.4	8.0	9.2	10.3	12.1	13.0	14.5	16.0	17.2
10	1/8" 1/4"	2.8	8.8	10.2	11.4	13.5	14.4	16.1	17.7	19.1
15	1/8" 1/4"	3.1	13.2	15.3	17.1	20.2	21.6	24.2	26.5	28.6
20	1/8" 1/4"	3.6	17.7	20.4	22.8	27.0	28.8	32.2	35.3	38.1
30	1/8" 1/4"	4.0	24.5	30.6	34.2	40.5	43.3	48.4	53.0	57.2
40	1/4"	4.4	35.3	40.8	45.6	54.0	57.7	64.5	70.6	76.3
50	1/4"	8.8	44.1	51.0	57.0	67.4	72.0	80.6	88.3	95.4